

TOWNSHIP 12 NORTH RANGE 39 EAST OF THE BOISE MERIDIAN CLARK COUNTY, IDAHO

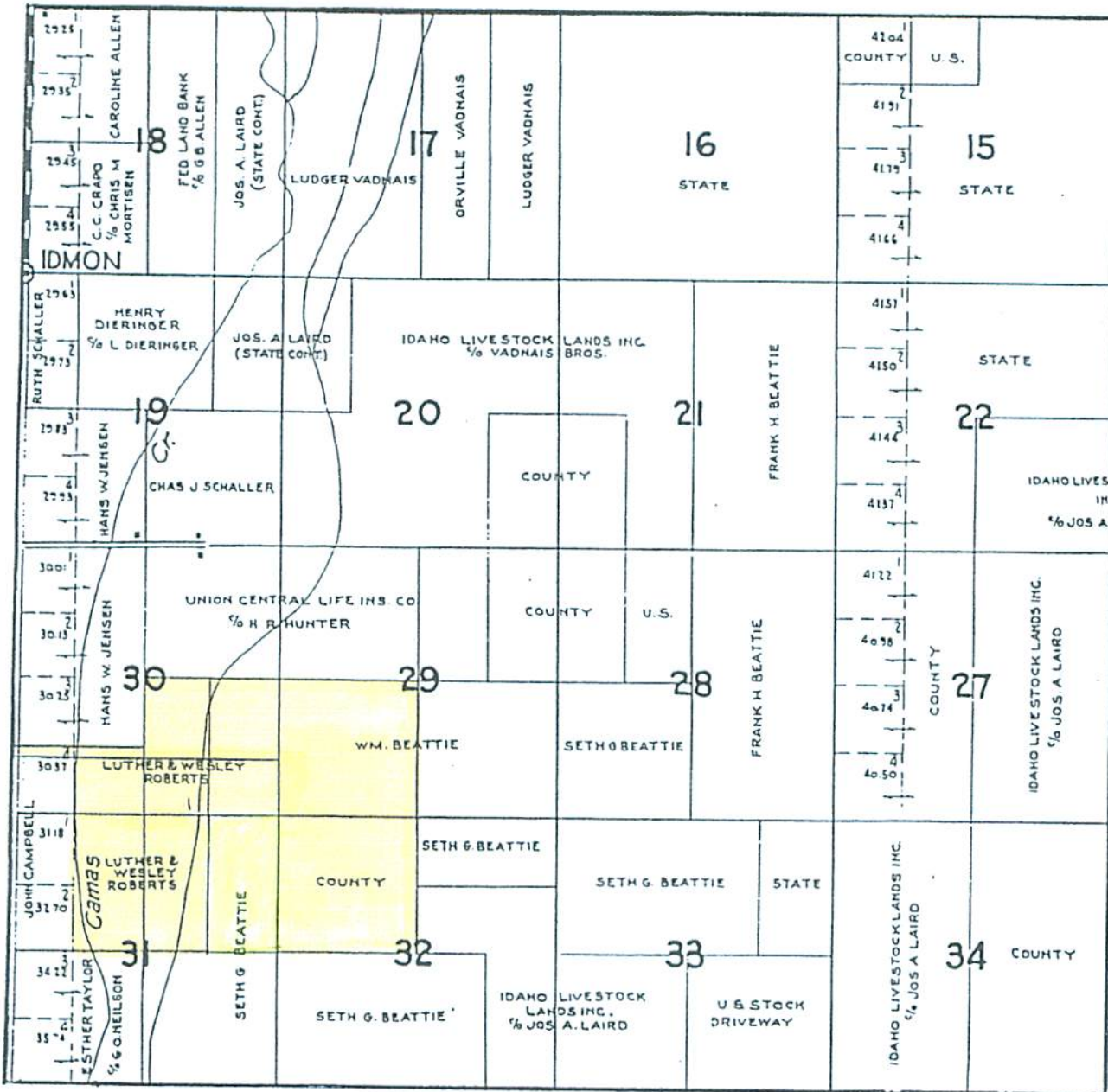

This plat is made solely for the purpose of assisting in locating said land. No representation is made as to accuracy and the company assumes no liability for any loss occurring by reason of reliance thereon.

Bonneville Land & Title Co.

497 N. Capital Ave • P.O. Box 51690 • Idaho Falls, ID 83405-1690 • (208) 524-6600 • Fax (208) 524-6072

TOWNSHIP 12 NORTH RANGE 38 EAST OF THE BOISE MERIDIAN CLARK COUNTY, IDAHO

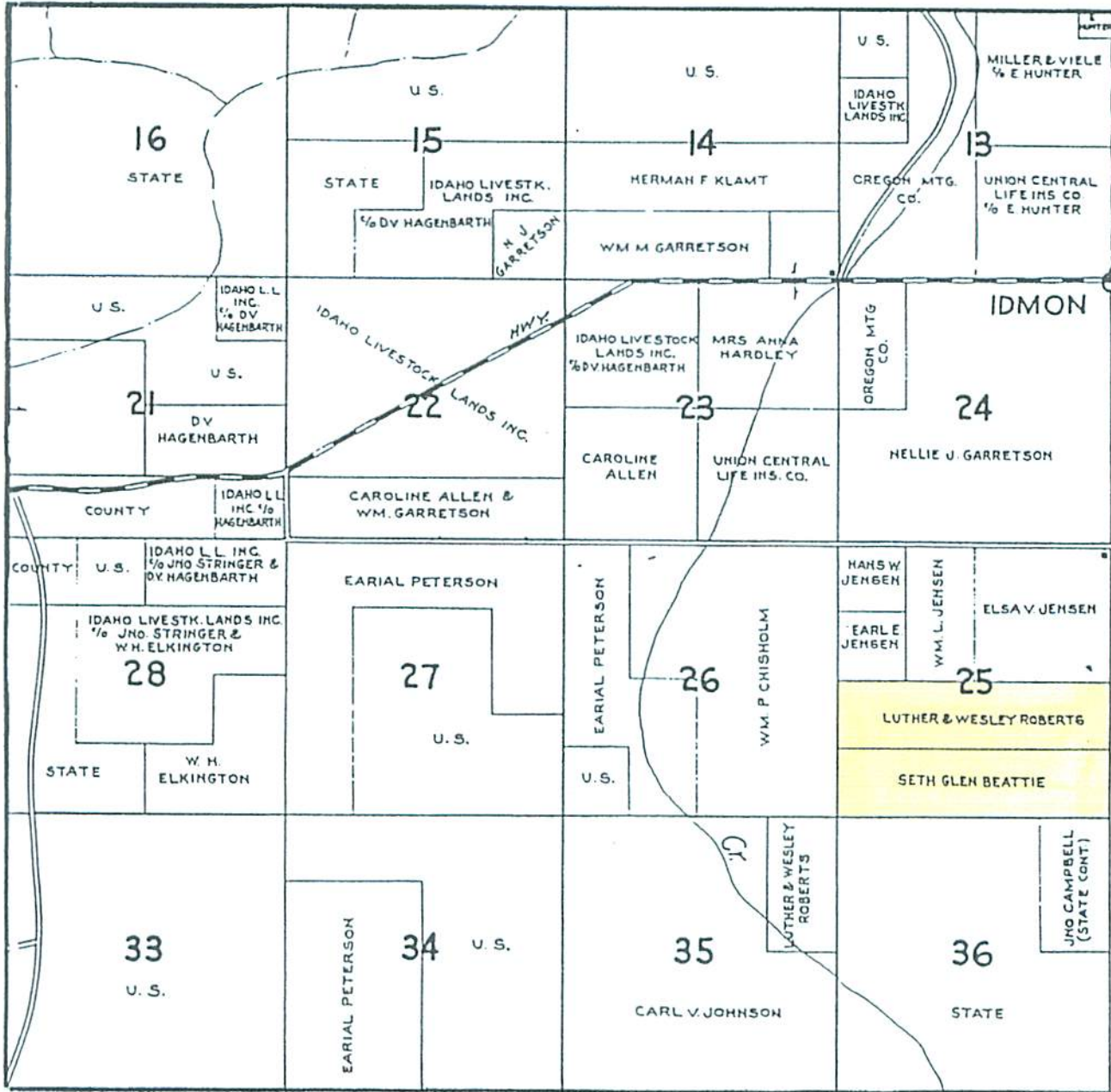

This plat is made solely for the purpose of assisting in locating said land. No representation is made as to accuracy and the company assumes no liability for any loss occurring by reason of reliance thereon.

Bonneville Land & Title Co.

497 N. Capital Ave • P.O. Box 51690 • Idaho Falls, ID 83405-1690 • (208) 524-6600 • Fax (208) 524-6072